

XIZI

Home Elevator

i520Pro-II i520S-G

XIZI2504



XIZI ELEVATOR CO.,LTD.

Add/NO.2329 Science and Technology Ave.,
Lin'an Economic Development Zone, Hangzhou, China
www.xizielevator.com

 Service Line / **400-826-1112**

This book is a general information print (Edition: First Edition, April 2024). We reserve the right to make changes to the product technology and specifications at any time.
The content of the sample is for reference only, and the actual product shall be subject to the contractual agreement between the parties and the actual product.

A Promise Of Happiness For Your Family

 **XIZI ELEVATOR**

Preface

XIZI Elevator Co., Ltd. is a comprehensive elevator manufacturing enterprise that integrates R&D, manufacturing, sales, installation, and after-sales service. Drawing on the four decades of elevator industry experience accumulated by the **XIZI 西子**® brand, the company possesses three major platforms: a R&D center, a smart manufacturing center, and a quality inspection center. Guided by green manufacturing and intelligent digital technology, the company remains committed to its corporate mission of "creating infinite possibilities for building transportation."

A i520Pro-II BASIC OVERVIEW

A Promise Of Happiness
For Your Family

| | |
|--------------------|--|
| Market positioning | Villa, Townhouse etc. private premises |
| Duty Load range | 250kg-400kg |
| Speed Range | 0.4m/s |
| Rise | 15m |
| Floors | 6/6/6 |

The Minimalist Geometry - 235 Series



Standard Decoration **Model: U-CR235-B**

Front Wall: Hairline Stainless Steel
Ceiling: Mirror Stainless Steel Frame + Track
Lights + Recessed LED Strip
Side Walls: Wood Grain Art Panels
Rear Wall: Wood Grain Art Panels + Stainless
Steel Trim + Recessed LED Strip
Floor: Grey Slate Tile

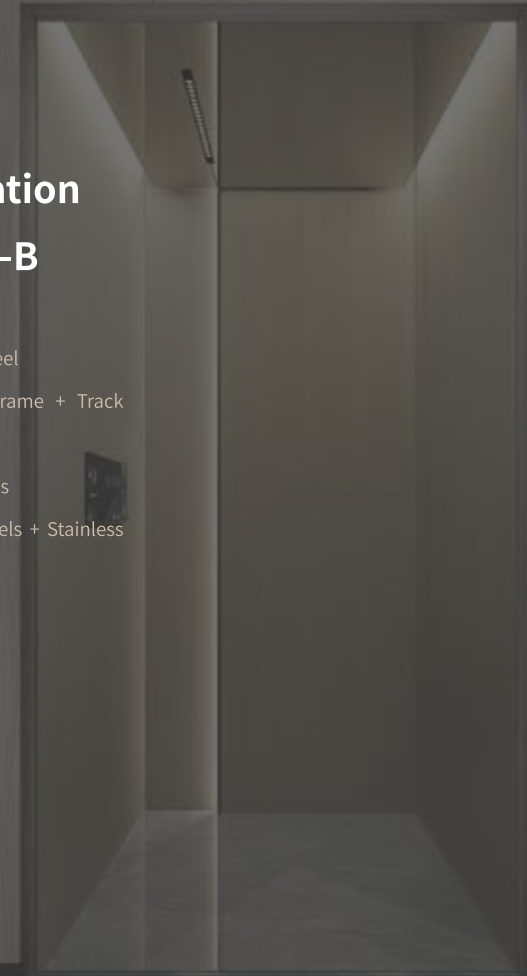

The Minimalist Geometry - 235 Series



(Standard Decoration) **Model: U-CR235-C**

Front Wall: Light Yellow Silver Sand Panel
Ceiling: Mirror Stainless Steel Frame + Track
Lights + Recessed LED Strip
Side Walls: Light Yellow Silver Sand Panel
Rear Wall: Light Yellow Silver Sand Panel +
Stainless Steel Trim + Recessed LED Strip
Floor: White Slate Tile



(Optional Decoration) **Model: U-CR235-A**

Front Wall: Artistic Aluminum Decorative Panel
Ceiling: Mirror Stainless Steel Frame + Track
Lights
Side Walls: Artistic Aluminum Decorative Panel
Rear Wall: Artistic Aluminum Decorative Panel +
Stainless Steel Trim + Recessed LED Strip
Floor: Grey Slate Tile



* The pictures on this page are for reference only.

Wood Grain Style



(Standard Decoration)

U-CR223

- Front wall: Hairline stainless steel
- Ceiling: Round & square ceiling
- Side walls: Mirror stainless steel + wood grain art plate.
- Rear wall: Mirror stainless steel + wood grain art plate
- Skirting line: Matteless black + welcome light
- Floor: White marble
- Recommended car door: Hairlines stainless steel



(Standard Decoration)

U-CR224

- Front wall: Hairline stainless steel
- Ceiling: Square ceiling
- Side walls: Mirror stainless steel + wood grain art plate
- Rear wall: Mirror stainless steel + wood grain art plate + hidden light strip
- Floor: Beige marble
- Recommended car door: Hairline stainless steel



(Standard Decoration)

U-CR225

- Front wall: Hairline stainless steel
- Ceiling: Round & square ceiling
- Side walls: Mirror stainless steel + wood grain art plate
- Rear wall: Mirror stainless steel + wood grain art plate
- Handrail: Mirror stainless steel
- Floor: White marble
- Recommended car door: Hairline stainless steel



* The pictures on this page are for reference only.

* The pictures on this page are for reference only.

Luxury Style



(Optional Decoration)

U-CR226

Front wall: Bronzed hairline stainless steel

Ceiling: Mirror stainless steel bronze plated frame
+ hidden light strip + downlight

Side wall: Leather pattern hard roll + hairline stainless steel
bronze inlaid strip

Back wall: Hairline stainless steel bronze plated decorative
strip + leather pattern hard roll + hidden light strip

Skirting line: Bronzed hairline stainless steel

Floor: Marble

Recommended car door: Bronzed hairline
stainless steel



(Optional Decoration)

U-CR227

Front wall: Rose gold mirror stainless steel

Ceiling: Rose gold mirror stainless steel frame
+ transparent acrylic

Side wall: Leather hard roll + rose gold mirror stainless
steel inlaid strip + rose gold mirror stainless steel

Rear wall: Leather hard roll + rose gold mirror stainless
steel inlaid strip + decorative luminaire

Skirting line: Rose gold mirror stainless steel inlaid
strip + hidden light strip

Floor: Marble

Recommended car door: Rose gold mirror
stainless steel



Glass Style



U-CR228

Front wall: Black titanium sandblasted stainless steel

Ceiling: Starry sky ceiling

Side wall: Sandblasted stainless steel + Lacquered glass (Matte black)

Rear wall: Paint glass (Matte black) + sandblasted stainless steel frame
+ paint glass (warm white) + hidden sandblasted armrest + hidden light strip

Skirting line: Sandblasted stainless steel + welcome light

Floor: Marble

Recommended car door: Black titanium sandblasted stainless steel



Ins Style



Model: U-CR241

Ceiling: Round & Square ceiling

Front wall: Wood grain art plate(straight grain oak)

Side wall: Wood grain veneer (straight oak) + aluminum profile insert (dark gray)

Rear wall: White art plate (moonlight white) + aluminum profile insert (dark gray)

+ splicing art plate (moonlight white splicing Cara gold marble)

Handrail: Champagne gold hairline stainless steel square handrail + hidden light strip

Floor: Marble



Model: U-CR240

Ceiling: Mirror stainless steel frame + strip floodlights
+ hidden light strip

Front wall: Wood grain art plate (zebra walnut)

Side wall: Wood grain art plate (zebra walnut)

Rear wall: Wood grain art plate (zebra walnut) + mirror
stainless steel with titanium black insert + hidden light
strip + marble art plate (cara gold marble) + curved art
finished decorative lamps

Floor: Marble (black and white)



Model: U-CR257

Ceiling: Positive white art steel plate + black trim frame
+ spotlight + hidden light strip

Front wall: Original color anti-fingerprint sandblasted
stainless steel

Side wall: Elegant light fabric art plate

Back wall: Elegant light fabric art plate + yellow and white
oak art plate + hidden light strip (rounded corner transitions
at side and rear wall junctions)

Handrail: Black titanium hairline stainless steel
+ hidden light strip

Floor: Art slate tile



* The pictures on this page are for reference only.

Modern Style



Model: U-CR258

Ceiling: Rose gold mirror stainless steel + spotlight + hidden light strip

Front wall: Rose gold sandblasted color plated anti-fingerprint stainless steel

Side wall: Elegant walnut art plate + rose gold sandblasted color plated anti-fingerprint stainless steel

Rear wall: Elegant walnut art plate + fish maw white stone art plate + hidden light strip (rounded corner transitions at side and rear wall junctions)

Floor: Slate tile



Model: U-CR252

Ceiling: Rough textured leather + mirrored stainless steel with antique brass plated frame +transparent acrylic

Front wall: Mirror stainless steel plated bronze

Side wall: Rough textured leather + black perforated breathable leather + stainless steel bronze insert + sandblasted titanium black stainless steel

Rear wall: Color-plated iridescent glass + hidden light strip

Handrail: Black perforated breathable leather + stainless steel copper plated mental cap

Skirting line: Mirror stainless steel plated bronze

Floor: Light brown embossed cashmere carpet



Model: U-CR251

Ceiling: Apple sandblasted stainless steel + Apple sandblasted stainless steel insert + transparent acrylic

Front wall: Apple sandblasted stainless steel

Side wall: Apple sandblasted stainless steel + sandblasted stainless steel inserts + brushed and cross-grained stainless steel

Rear wall: Apple sandblasted stainless steel + sandblasted stainless steel insert + champagne gold brushed perforated stainless steel + transparent acrylic + brushed and cross-grained stainless steel (rear wall arc transition)

Skirting line: Champagne gold sandblasted stainless steel

Floor: Marble



Elegant Style



Model: U-CR253

Ceiling: Porcelain white brushed stainless steel plate

+ rose gold mirror stainless steel + hidden light strip

Front wall: Rose gold mirror stainless steel

Side wall: Porcelain white brushed stainless steel plate

+ rose gold mirror stainless steel + iridescent glass

Rear wall: Rose gold mirror stainless steel

+ gilt age slate tile

Handrail: Rose gold mirror stainless steel

Floor: Marble



Model: U-CR254

Ceiling: Anti-fingerprint sandblasted stainless steel bronze

plated frame + black arc track light

Front wall: Anti-fingerprint sandblasted stainless steel

bronze plated

Side wall: Mirror stainless steel bronze plated

+ anti-fingerprint sandblasted stainless steel bronze plated

+ hidden light strip

Rear wall: Translucent marble + mirror stainless steel bronze

insert + green diamond lattice soft package

Handrail: Bronze aluminum oxidation

Floor: Marble



Warm Style



Model: U-CR255

Ceiling: Mirror stainless steel + mirror stainless steel plated bronze insert
+ transparent acrylic + hidden light strip

Front wall: Mirror stainless steel bronze plated

Side wall: Horizontal light wood grain solid wood panel
+ mirror stainless steel bronze plated insert

Rear wall: Vertical light wood grain solid wood panel + mirror stainless
steel bronze plated insert + white lacquered grille plate

Handrail: Concave mirror stainless steel bronze plated
+ hidden light strip + leather wrapped

Skirting line: Mirror stainless steel bronze plated + hidden light strip

Floor: Marble



Model: U-CR256

Ceiling: Warm white lacquered steel plate + spotlight

Front wall: Black titanium mirrored stainless steel

Side wall: Black lacquered steel plate frame + warm white lacquered glass

Rear wall: Black lacquered steel plate frame + warm white lacquered glass
+ Hermes orange hard leather

Handrail: Black lacquered steel plate frame + hidden light strip

Skirting line: Black lacquered steel plate

Floor: Marble



Simple



U-CR161



U-CR202



U-CR162



U-CR217

Neo-chinese Style



U-CR219-1



U-CR208-1



U-CR212



U-CR205

Optional Flooring



U-FL101
(Carpet)



U-FL102
(Carpet)

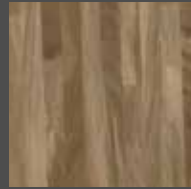

U-FL103
(Pattern PVC)

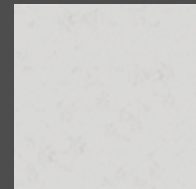

U-FL300
(White Marble)



U-FL301
(Beige Marble)

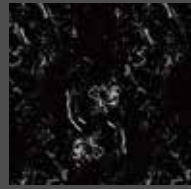

U-FL091
(Black and White Marble)



Optional Ceiling



U-CL122 (integrated)
Powder coated steel (Pearl Silver)
+Downlight



U-CL123-1 (integrated)
Hairline St. Steel + Panel Light



U-CL300 (Split type)
Powder coated steel frame (crescent white)
+ bronzed stainless steel frame
+ hidden light strip + Downlight



U-CL301-B (Split Type)
Starry Sky Ceiling



U-CL305 (Split Type)
Upper Ceiling with Powder-Sprayed Steel
Plate (Crescent White) + Warm Light
Recessed Strip + Powder-Sprayed Steel
Frame + Spotlights



U-CL306 (Split Type)
Round and Square Ceiling

Human Interface

Rhyme Series

Interpreting minimalist aesthetics through curved lines

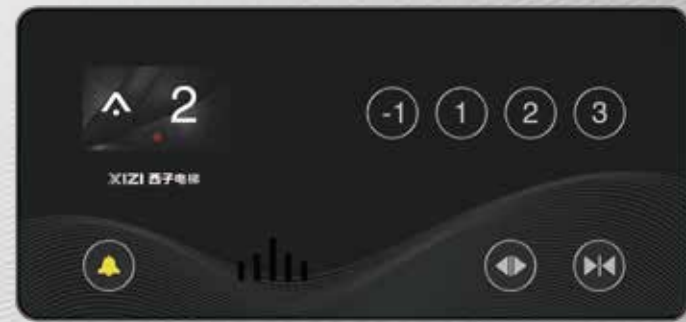

U-CF6000

COP

Model: U-CF6000
Display: 4.3-inch TFT Display
Buttons: Mechanical Buttons
Panel: Glass



U-ZW6000

LOP

Model: U-ZW6000
Display: 4.3-inch LED Segment Display
Buttons: Mechanical Buttons
Panel: Glass + Aluminum Alloy Housing

Human Interface

Ultimate Vision Series

Textured Glass



U-CF3000-A (Standard)

*Optional Mechanical Buttons



U-CF3000-B

COP

Model: U-CF3000
Display: 4.3-inch TFT LCD Display
Buttons: Touch Buttons
Panel: Glass Panel



U-CF3001-A



U-CF3001-B

*Optional Mechanical Buttons

COP

Model: U-CF3001
Display: 4.3-inch TFT LCD Display
Buttons: Touch Buttons
Panel: Metal Frame + Glass Panel



TL-200-A



TL-200-D

LOP

Model: TL-200
Display: LED Segment Display
Buttons: Microswitch Buttons
Panel: Glass Panel



TL-400N-A



TL-400N-B

LOP

Model: TL-400N
Display: LED Segment Display
Buttons: Touch Buttons
Panel: Frosted Glass Panel



U-ZW2300-A



U-ZW2300-B

LOP

Model: U-ZW2300
Display: 4.3-inch LED Segment Display
Buttons: BR36F
Panel: Acrylic + Stainless Steel Housing



Human Interface

COP



COP
 Model: U-CY1800
 Display: 7-inch TFT Vertical Display - White Elegance
 Buttons: BR34G
 Installation Position: Side Mounted
 Panel Material: Matches the Material of the Car Wall



COP
 Model: U-CF3700
 Display: 10.1" TFT LCD touch display
 Button: Virtual + touch button



LOP
 Model: U-ZW4200
 Display: 4.3" LED segment code display
 Button: Touch button
 Panel: Glass panel + aluminum sandblasted frame



LOP
 Model: U-ZW4100
 Button: Mechanical button
 Panel: Black glass + aluminum sandblasted frame



LOP (With Base Box)
 Model: U-ZY8800
 Panel Material: Glass + Aluminum Alloy Frame
 Display: TFT LCD Touch Display
 Buttons: Virtual Buttons



LOP (With Base Box)
 Model: TL-500
 Panel: TFT LCD touch display

LOP

B

i520S-G

BASIC OVERVIEW

Designed with transparent car decoration, the i520S-G series sightseeing home lift provides passengers with a broader field of vision, present an excellent and efficient sightseeing experience.

The safety system has been fully upgraded and adopts high-quality parametric design to meet the individual needs of different passengers.

The i520S-G series sightseeing home lift is committed to providing passengers with a safer and more comfortable riding experience.

| | |
|--------------------|--|
| Market positioning | Villa, Townhouse etc. private premises |
| Duty Load range | 250kg-400kg |
| Speed Range | 0.3-0.4m/s |
| Rise | 15m |
| Floors | 6/6 |

Decoration



U-CR935-A (Std)

- Front Cabin: Champagne Gold Sheet Metal Painted
- Ceiling: White Translucent Acrylic + Black Aluminium Alloy
- Frame
- Three Cabins(except side middle): Champagne Gold Aluminium Alloy + Laminated Tempered Glass
- Side Middle Cabin: Black Titanium Mirror + Strip Lights on Both Sides
- Outer Sealing Plate/Lintel: Sheet Metal (Galvanized) Painted
- Kick Plate: Champagne Gold Aluminium Alloy
- Floor: Jazz White Marble



U-CR935-B

- Front Cabin: Black Titanium Sheet Metal Painted
- Ceiling: White Translucent Acrylic + Black Aluminium Alloy
- Frame
- Three Cabins(except side middle): Titanium Black Aluminium Alloy + Laminated Tempered Glass
- Side Middle Cabin: Black Titanium Mirror + Strip Lights on both Sides
- Outer Sealing Plate/Lintel: Sheet Metal (Galvanized) Painted
- Kick Plate: Titanium Black Aluminium Alloy
- Floor: Jazz White Marble



Decoration



U-CR935-C

Front Cabin: Warm White Sheet Metal Painted
Ceiling: White Translucent Acrylic + Black Aluminium Alloy
 Frame
Three Cabins(except side middle): Warm White
 Aluminium Alloy + Laminated Tempered Glass
Side Middle Cabin: Black Titanium Mirror + Strip Lights
 on Both Sides
Outer Sealing Plate/Lintel: Sheet Metal
 (Galvanized) Painted
Kick Plate: Warm White Aluminium Alloy
Floor: Jazz White Marble



U-CR935-D

Front Cabin: Violet-blue Sheet Metal Painted
Ceiling: White Translucent Acrylic + Black Aluminium Alloy
 Frame
Three Cabins(except side middle): Violet-blue
 Aluminium Alloy + Laminated Tempered Glass
Side Middle Cabin: Black Titanium Mirror + Strip Lights
 on Both Sides
Outer Sealing Plate/Lintel: Sheet Metal
 (Galvanized) Painted
Kick Plate: Violet-blue Aluminium Alloy
Floor: Jazz White Marble



Optional Car Decoration



U-CR936

Front Cabin: Mirror Stainless Steel
Ceiling: Lower Hanging Painted Steel + Upper Painted Steel
 + Hidden Lamp (neutral light) + Spotlights
Door Sills: Outer Powder-coated steel plate (color
 consistent with hoistway), Inner Mirror Stainless Steel
Cabins: Mirror Stainless Steel + Mirror Stainless Steel Insert
 + Cloth Texture Film Plate + Laminated Tempered Glass
Handrail: Mirror Stainless Steel + Cloth Texture Steel Plate
Kick Plate: Mirror Stainless Steel
Floor: Marble



U-CR927-1

Front Cabin: Apple Sand Stainless Steel
Ceiling: Aluminium Profile Drawing Film
Cabin & Door Sills Inner: Apple Sand Stainless Steel
 + Laminated Tempered Glass
Outer wrapped: Color consistent with Hoistway
Floor: Marble



U-CR929-A

Front Cabin: Mirror Stainless Steel
Ceiling: Upper Painted Steel(Crescent white)(+ Hidden
 Lamp (warm light) + Painted Steel Plate Frame(Crescent
 White)
Cabins: Mirror Stainless Steel + Laminated Tempered Glass
Outer wrapped: Color consistent with Hoistway
Floor: Carpet

Ceiling

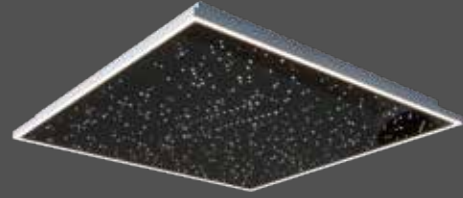

U-CL301-A Starry Sky Ceiling

*Only available for U-CR935 Series Decoration Option

Landing Door



Center Opening Door(Std)



Center Opening Double Fold Door



Side Opening Door



Hand Sliding Door

*The optional colors for the hoistway door are consistent with the optional colors for the hoistway frame.

*All the hoistway doors mentioned above are aluminum alloy framed glass doors.

Hoistway Options

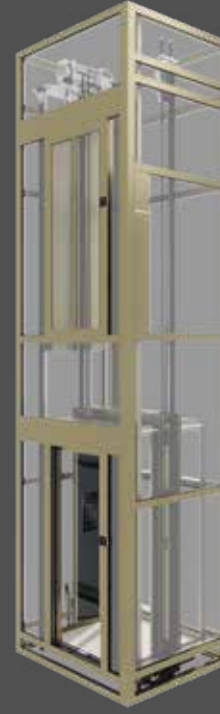

Champagne Gold

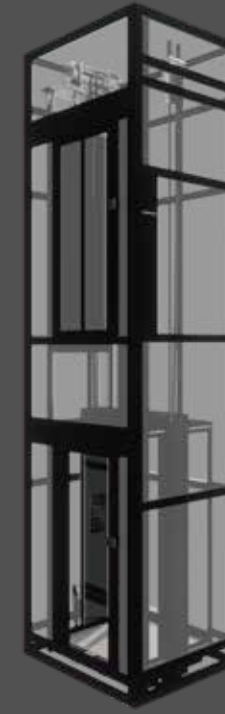

Black Titanium



Warm White

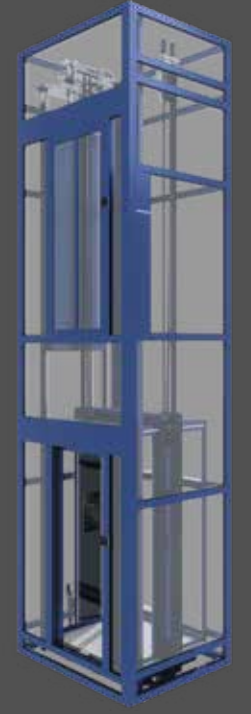

Violet-blue

Optional Colors for the Hoistway



Matt Brown Red
XZ-LHJ-01



Antique Copper Rose Gold
XZ-LHJ-02



Hermès Orange
XZ-LHJ-03



Matt Red
XZ-LHJ-04



Shimmering Gold
XZ-LHJ-05



Haze Blue Grey*
XZ-LHJ-06



Gentleman Grey*
XZ-LHJ-07



Diamond Black*
XZ-LHJ-08



Purple Red Frosted*
XZ-LHJ-09



Deep Silver Grey*
XZ-LHJ-10

Note: When configuring the hoistway frame colors with an asterisk (*), the elevator components inside the hoistway will be sprayed with RAL9005 Titanium Black.

Standard Optional Interface



U-CF3001N-A U-CF3001N-B

* Mechanical Button Optional

COP (Std)
 Type: U-CF3001N
 Display: 4.3" TFTL LCD
 Button: Touch Button (Mechanical Button Optional)
 Panel: Metal Frame + Glass Panel



TL-400N-A TL-400N-B

LOP (Std)
 Type: TL-400N
 Display: LED Segment Display
 Button: Push Button
 Panel: Frosted Glass Panel

COP (Optional)
 Type: U-CY1800
 Display: 7-inch TFT Vertical Display - White Elegance
 Button: BR34G
 Installed Position: Side Positioned
 Panel Material: Consistent with Cabin Material



COP (Optional)
 Type: U-CF2700-1
 Button: BR34G Apple Sand
 Panel Material: Apple Sand Metal



COP (Optional)
 Type: U-CF3700
 Display: 10.1" TFT LCD Touch Display
 Button: Dummy + Touch Button



TL-200-A TL-200-D

LOP (Optional)
 Type: TL-200
 Display: LED Segment Display
 Button: Micro-button
 Panel: Glass



LOP (Optional)
 Type: TL-500
 Panel: Glass
 Display: TFT LCD Touch Display



LOP (Optional)
 Type: BR36F
 Button: Mechanical Button LOP



Landing Door Preferences

Door Jamb Options:



Small Door Jamb (Standard)



Wide Jamb (Optional)

Finish Process Options for Landing Door:



Hairline Stainless Steel



Mirror Stainless Steel



Sandblasted Stainless Steel

Color Coating Options for Landing Door:



Titanium Gold



Titanium Black



Bronze



Rose Gold



Champagne Gold



Landing Door Preferences

Metal landing door (For Center Opening Door Only):



U-D031

Champagne Gold Hairline Etching St. Steel



U-D033

Rose Gold Hairline Etching St. Steel



U-D034

Bronze Mirror Etching St. Steel



U-D031

Champagne Gold Hairline Etching St. Steel

Aluminum Panel Hall Doors:



U-D302

Material: Fabric Texture Coffee



U-D303

Material: Matte Light Coffee



Premium Configuration



Controller

Installation

Standard side wall mounting, optional embedded mounting

Improve Space Utilization

Small size, easy to install

Energy saving and environmental protection

Low power consumption in standby

Enjoy the Exclusive Configuration

Equipped with contactless technology to enjoy an immersive elevator ride experience;



Energy Saving Traction Machine

High Efficiency and Energy Saving

With the low power consumption traction and the standby power consumption, which realizes the maximum energy saving.

Space Optimization

Equipped with the new rare earth permanent magnet synchronous gearless energy-saving traction, the size is 70%-80% smaller than that of the ordinary traction.

Stable Operation

The traction sheave adopts an arc-shaped section design and the surface of the spoke is coated, which make the elevator run more stably.



Steel Belt

The steel wire rope wrapped with high-tech, new wear-resistant material polyurethane layer, eliminating grease lubrication, characteristic with longer life, more environmentally friendly.



Absolute Position Control System (Standard)

Artistic

The leveling switch, reduction switch, bracket, strike bow and other components are intergrated, which makes the shaft more good looking.

Precise

The control is more precise and stable, the control accuracy reaches 0.0625mm; the speed detection accuracy reaches 0.025m/s



Comfortable And Exclusive Experience

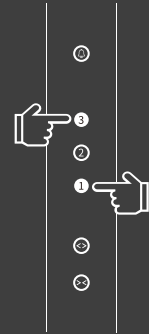

COP Self-Rescue Function (Standard)

When the elevator has a specific fault and the passengers are trapped in the car, the nearest door can be opened by the operation on the cop panel.

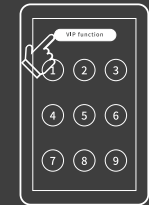

COP function (optional)

- VIP floor service function
- Connect to WIFI for real-time weather updates
- DIY music and wallpaper

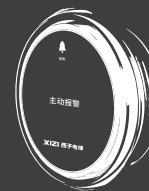

Abnormal monitoring function in the car (optional)

·After entering the elevator, the elevator will be actively monitored and reminded if it has not been moved for a long time.



ARD Automatic Rescue Device (Standard)

Built-in lithium battery, effectively release the cabin to the nearest floor.



LOP function (optional)

- Child lock function
- Voice call function
- Automatic ladder locking function



Elevator Energy Management System (Optional)

- Ensures normal operation of the elevator for a certain period of time during a power outage
- Effectively eliminates the impact of fluctuations in the power grid, maintaining normal elevator operation
- The system comes with a low battery protection function to eliminate the risk of passengers being trapped
- Saves electricity, with a comprehensive power saving rate of 20%~45% (optional)

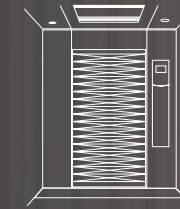

Automatic monitoring of door area safety (optional)

·Laser light curtain recognition for landing doors, which can accurately confirm the status of string objects.



Intelligent Maintenance Reminder (Optional)

·You can set the next maintenance time, and take the initiative to remind you before the maintenance expires.



Intelligent Variable Speed (Optional)

The elevator intelligent speed change function can be operated according to specific scenarios.

Function List

● Standard ○ Optional

| Function | Description | Note |
|--|---|------|
| Self-rescue leveling running | When the elevator is not in maintenance mode, and did not stop on the leveling area, when meeting the safety requirements, the elevator will automatically run at slow to a leveling area, and then open the door. | ● |
| Emergency rescue running | When manual winding required over 400N, set up the emergency electric operation switch and operation, to replace manual winding | ● |
| One-click distress function | Call the intercom host on the COP through the talk button. When there is no answer, the intercom host will automatically dial the 3 phone numbers (or mobile phones) set in turn until it is connected. | ● |
| ARD Automatic rescue function | When the running car is not in the door area and the person is trapped due to the power failure of the building, the power failure emergency leveling device will start, driving the elevator to run to the door area at a low speed to open the door and release the person. | ● |
| In-Car autonomous rescue function | When the passenger is trapped in the cabin, if the elevator fault is a recoverable fault and does not affect the safe operation of the elevator, the passenger can press the top and bottom buttons at the same time and hold it for more than 10 seconds. In this way, the elevator can temporarily shield the fault and run to the leveling position automatically, open the door to release people, and lock the elevator. | ● |
| Child safety lock | The HOP has the function of password setting and elevator locking to prevent children from operating the elevator and avoid the possible danger. | ○ |
| Absolute position system | The control cabinet can be configured with an absolute position system, which can greatly reduce the hoistway components and optimize the hoistway space | ● |
| VIP floor service function | After setting a password for a specified floor, if you want to register for that floor, you need to enter the password before you can register successfully | ○ |
| Abnormal monitoring function in the car | After entering the elevator, the elevator will be actively monitored and reminded if it has not been moved for a long time. | ○ |
| Automatic monitoring of door area safety | Laser light curtain recognition for landing doors, which can accurately confirm the status of string objects. | ○ |
| Intelligent Maintenance Reminder | You can set the next maintenance time, and take the initiative to remind you before the maintenance expires. | ○ |
| Intelligent Variable Speed | The elevator intelligent speed change function can be operated according to specific scenarios. | ○ |

More functions please contact our sales.

· Scan code to understand the XIZI Elevator ·



More products are at hand

Civil engineering layout

i520 Pro II Civil Engineering Drawings Counterweight Rear-Mounted Side-Opening Door

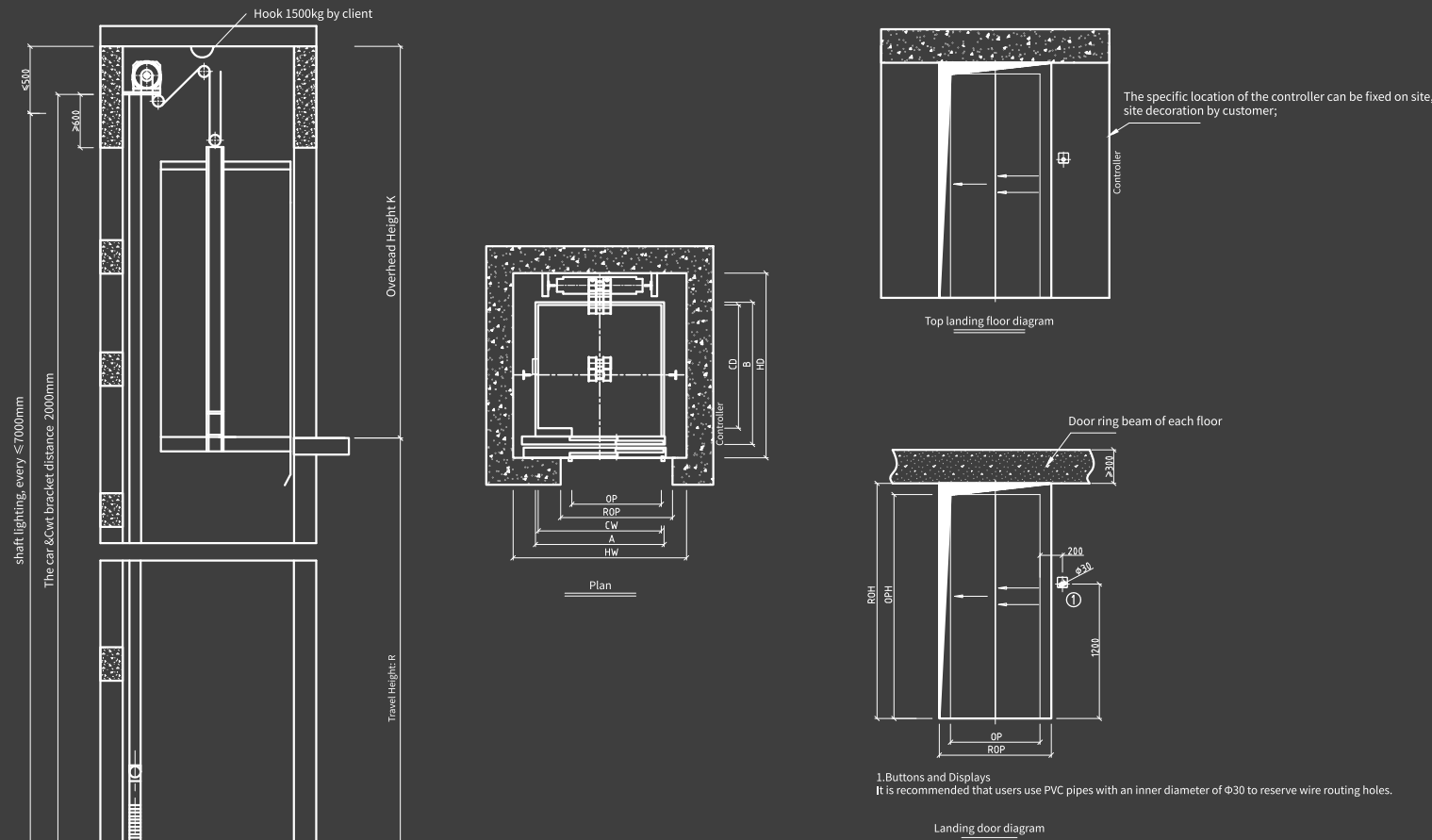

| | L (Load Capacity) | DS (Door System) | CP (Counterweight Position) | HW (Hoistway Clear Width) | HD (Hoistway Clear Depth) | CW (Car Clear Width) | CD (Car Clear Depth) | OP (Net Door Opening) | CRH (Car Clear Height) | K (Overhead Height) | S (Pit Depth) |
|-------------|----------------------|---------------------|--------------------------------|------------------------------|------------------------------|-------------------------|-------------------------|--------------------------|---------------------------|------------------------|------------------|
| i520 Pro II | 250 | Side-Opening Door | Counterweight rear-mounted | 1300 | 1500 | 950 | 950 | 650 | 2200 | 3000 | 250 |
| | 320 | | | 1350 | 1600 | 1000 | 1050 | 700 | | | |
| | 400 | | | 1450 | 1650 | 1100 | 1100 | 800 | | | |

i520 Pro II Civil Engineering Drawings Counterweight Rear-Mounted Center-Opening Door

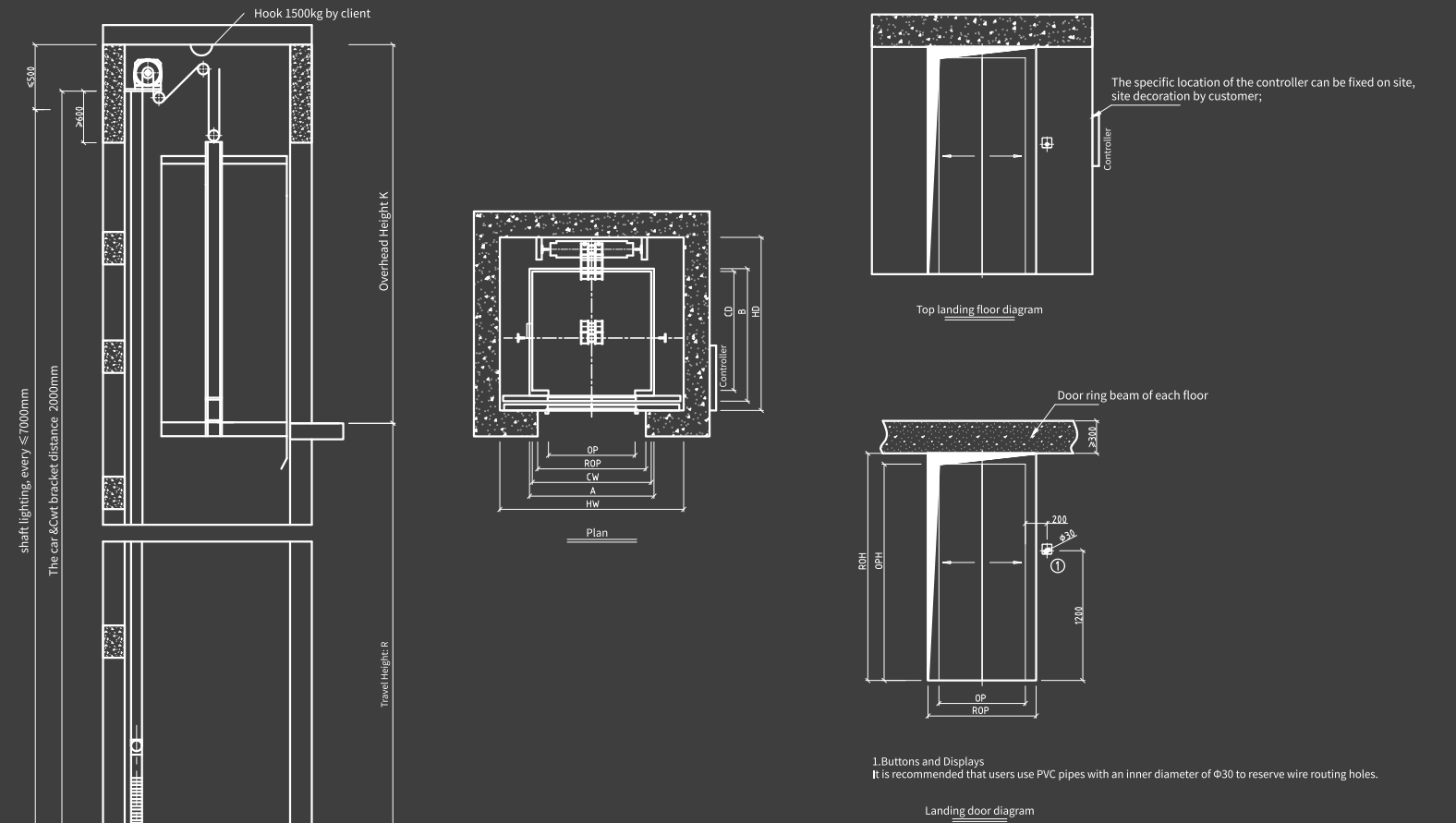

| | L (Load Capacity) | DS (Door System) | CP (Counterweight Position) | HW (Hoistway Clear Width) | HD (Hoistway Clear Depth) | CW (Car Clear Width) | CD (Car Clear Depth) | OP (Net Door Opening) | CRH (Car Clear Height) | K (Overhead Height) | S (Pit Depth) |
|-------------|----------------------|---------------------|--------------------------------|------------------------------|------------------------------|-------------------------|-------------------------|--------------------------|---------------------------|------------------------|------------------|
| i520 Pro II | 250 | Center-Opening Door | Counterweight rear-mounted | 1300 | 1450 | 950 | 950 | 600 | 2200 | 3000 | 250 |
| | 320 | | | 1350 | 1550 | 1000 | 1050 | 600 | | | |
| | 400 | | | 1450 | 1600 | 1100 | 1100 | 650 | | | |

Civil engineering layout

i520 Pro II Civil Engineering Drawings Counterweight Side-Mounted Side-Opening Door

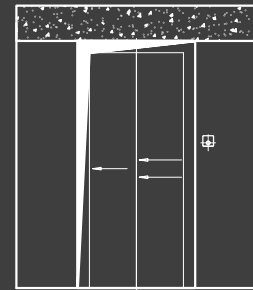
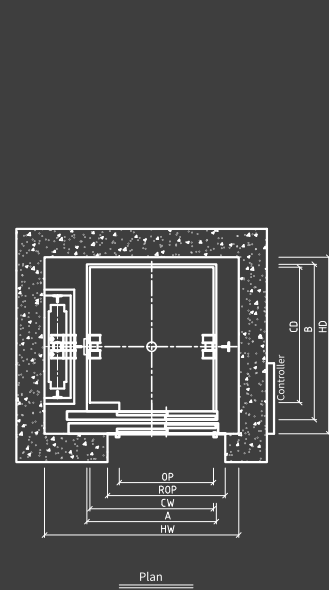
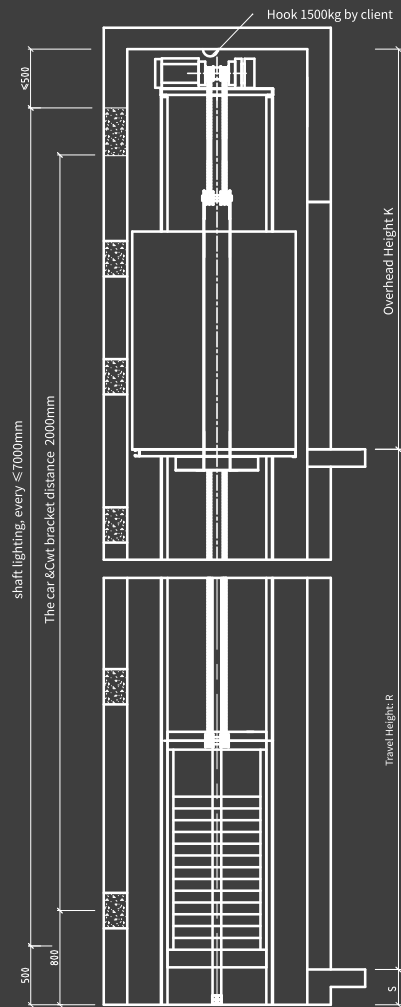

Top landing floor diagram

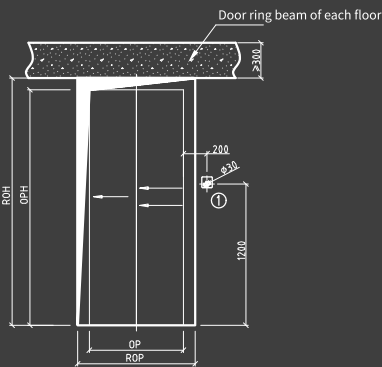

1. Buttons and Displays
It is recommended that users use PVC pipes with an inner diameter of Φ30 to reserve wire routing holes.

Landing door diagram

| | L (Load Capacity) | DS (Door System) | CP (Counterweight Position) | HW (Hoistway Clear Width) | HD (Hoistway Clear Depth) | CW (Car Clear Width) | CD (Car Clear Depth) | OP (Net Door Opening) | CRH (Car Clear Height) | K (Overhead Height) | S (Pit Depth) |
|-------------|----------------------|---------------------|--------------------------------|------------------------------|------------------------------|-------------------------|-------------------------|--------------------------|---------------------------|------------------------|------------------|
| i520 Pro II | 250 | Side opening | Counterweight side mounted | 1400 | 1350 | 900 | 1000 | 650 | 2200 | 2850 | 250 |
| | 320 | | | 1500 | 1400 | 1000 | 1050 | 800 | | | |
| | 400 | | | 1600 | 1450 | 1100 | 1100 | 800 | | | |

i520 Pro II Civil Engineering Drawings Counterweight Side-Mounted Center-Opening Door

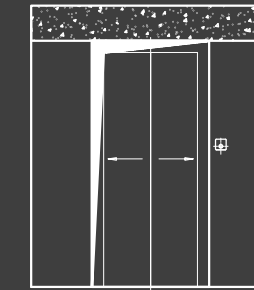
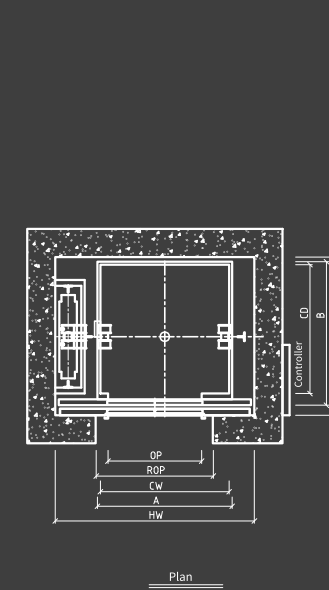
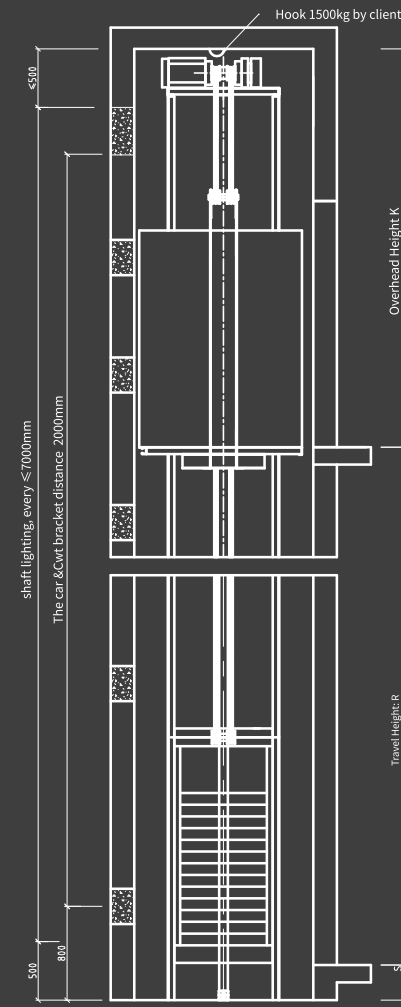

Top landing floor diagram

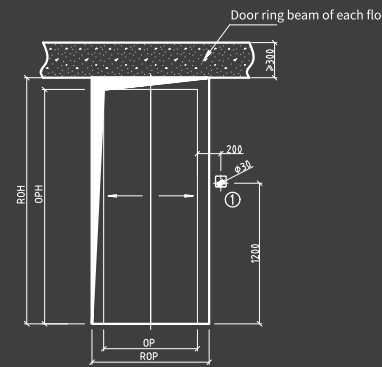

1. Buttons and Displays
It is recommended that users use PVC pipes with an inner diameter of Φ30 to reserve wire routing holes.

Landing door diagram

| | L (Load Capacity) | DS (Door System) | CP (Counterweight Position) | HW (Hoistway Clear Width) | HD (Hoistway Clear Depth) | CW (Car Clear Width) | CD (Car Clear Depth) | OP (Net Door Opening) | CRH (Car Clear Height) | K (Overhead Height) | S (Pit Depth) |
|-------------|----------------------|---------------------|--------------------------------|------------------------------|------------------------------|-------------------------|-------------------------|--------------------------|---------------------------|------------------------|------------------|
| i520 Pro II | 250 | Center opening | Counterweight side mounted | 1400 | 1250 | 900 | 1000 | 650 | 2200 | 2850 | 250 |
| | 320 | | | 1500 | 1300 | 1000 | 1050 | 700 | | | |
| | 400 | | | 1600 | 1350 | 1100 | 1100 | 750 | | | |

Civil engineering layout

i520S-G Center Opening Door with Counterweight Side Located

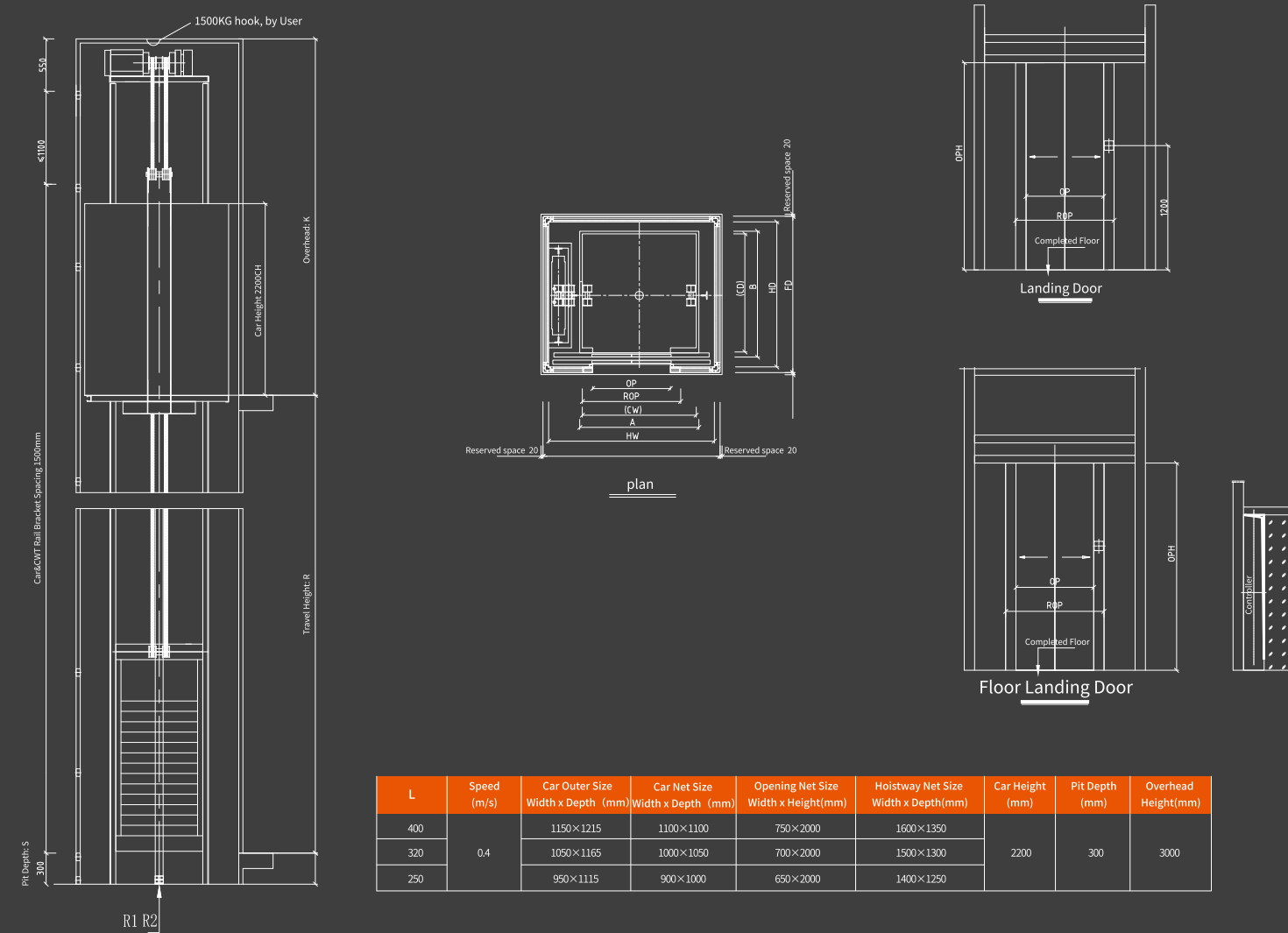

i520S-G Side Opening Door with Counterweight Side Located

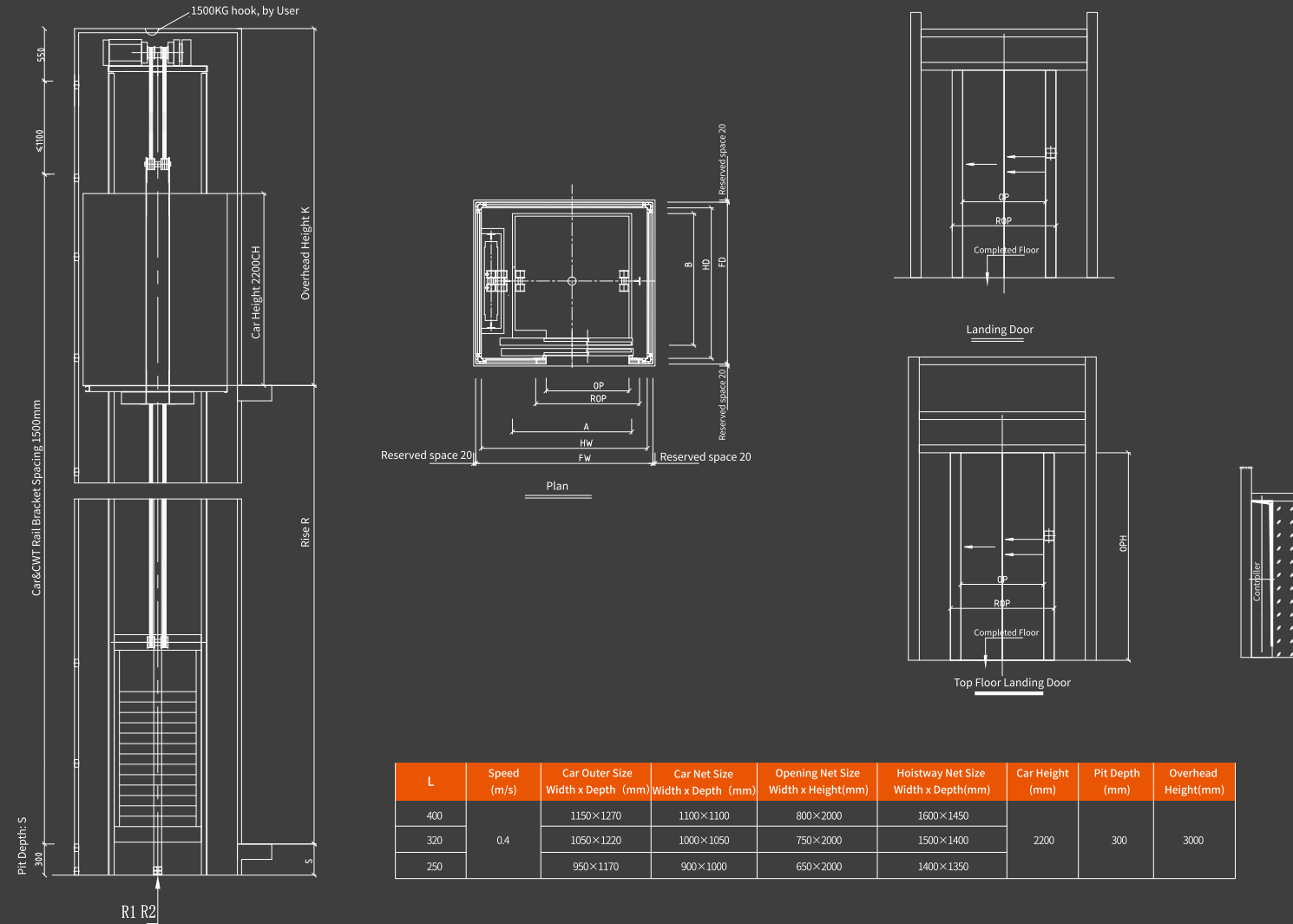

Civil engineering layout

i520S-G 4-P Center Opening Door with Counterweight Side Located

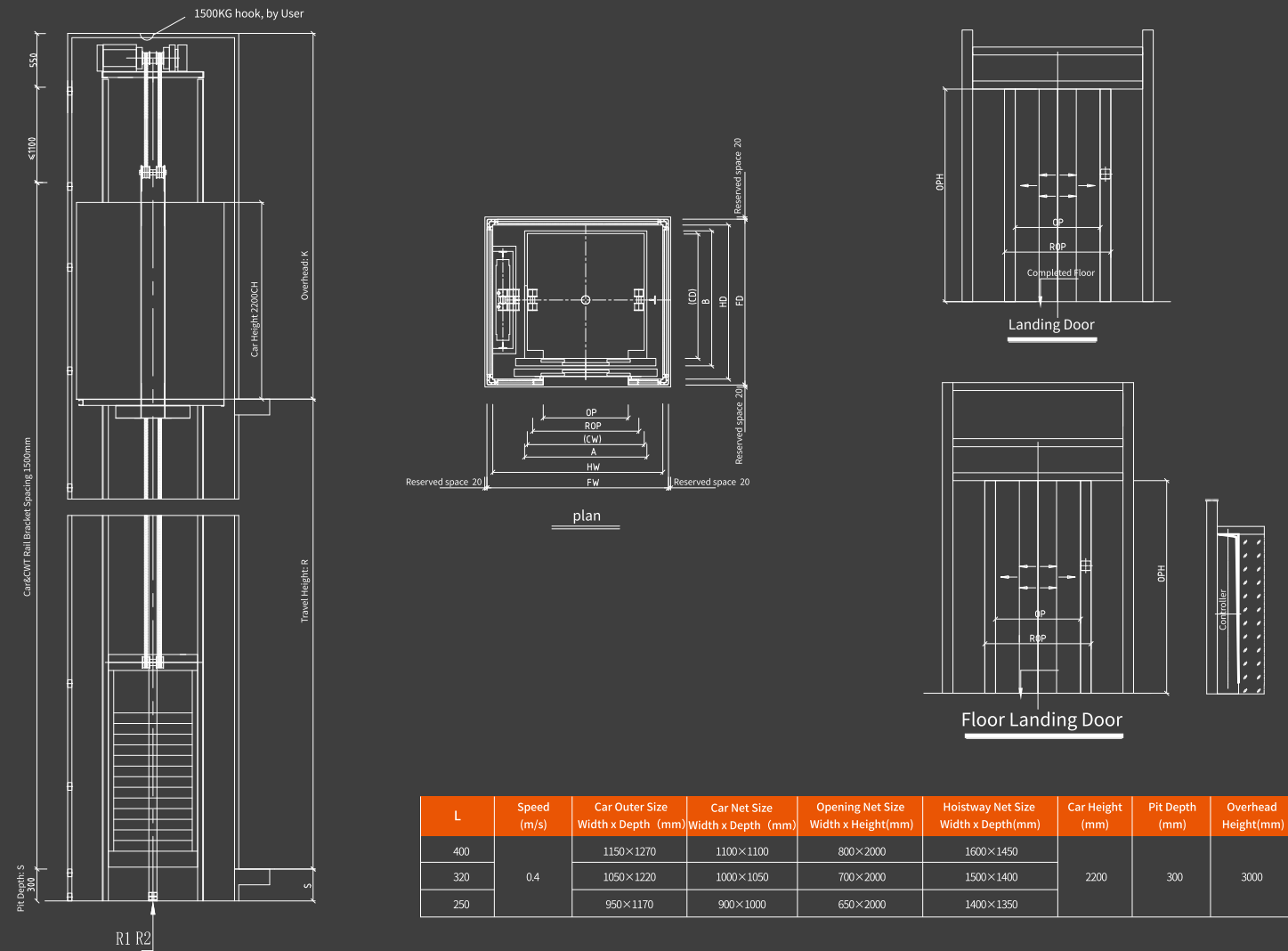

i520S-G Hand Sliding Door with Counterweight Side Located

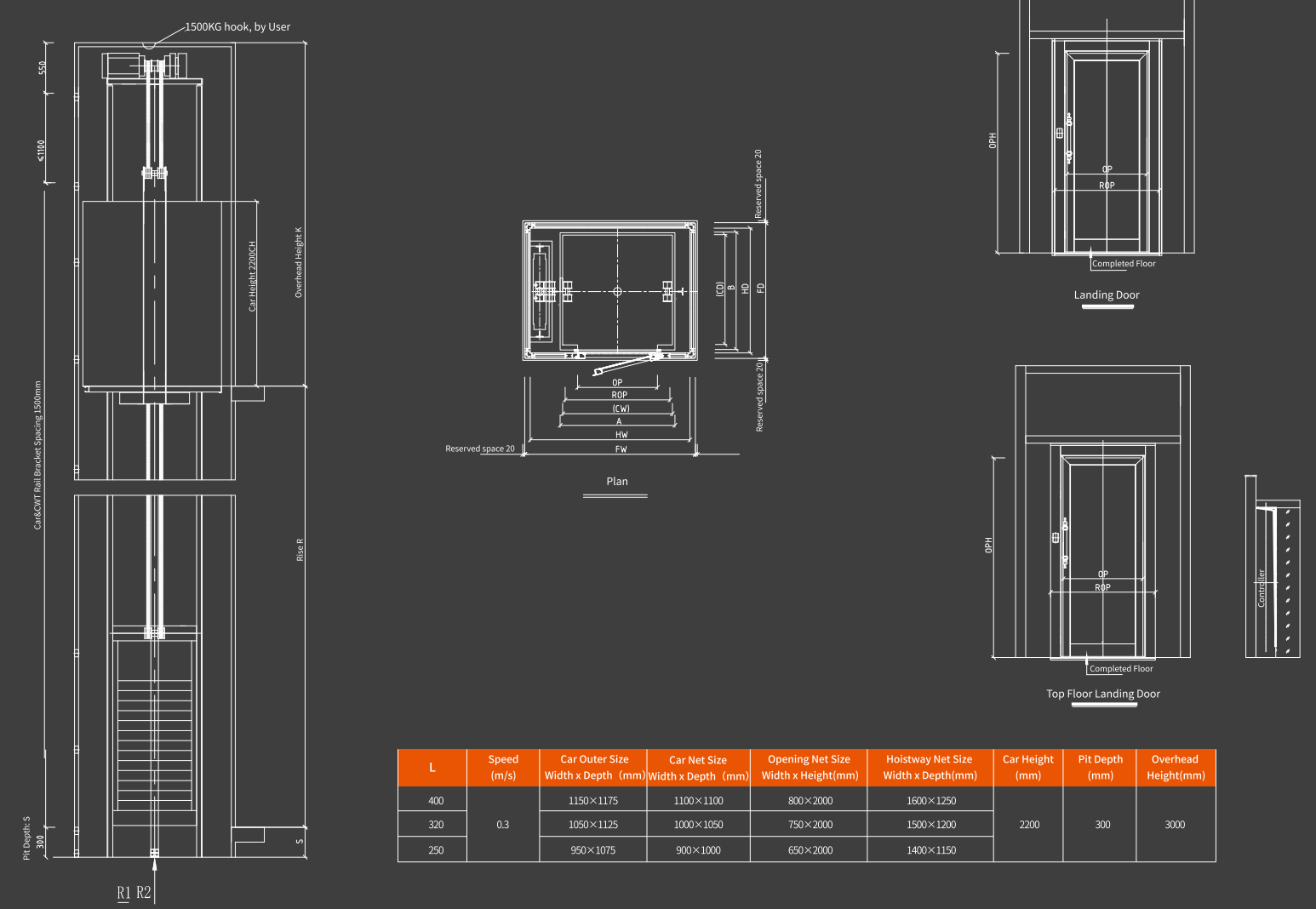

Civil engineering layout

i520S-G Center Opening Door with Counterweight Rear Located

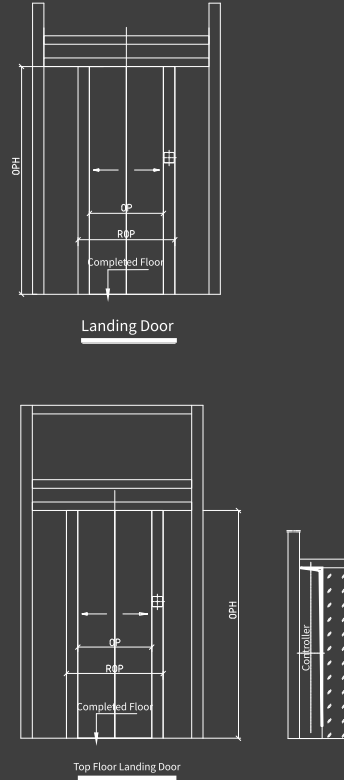
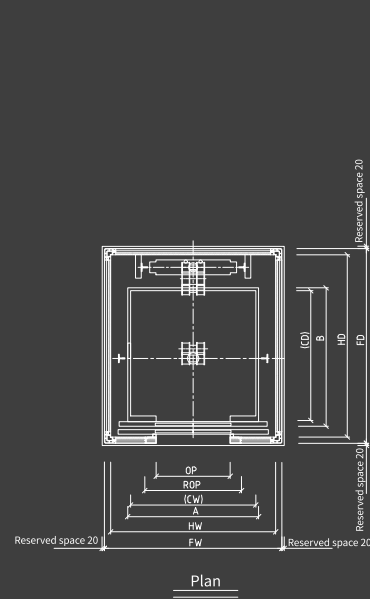
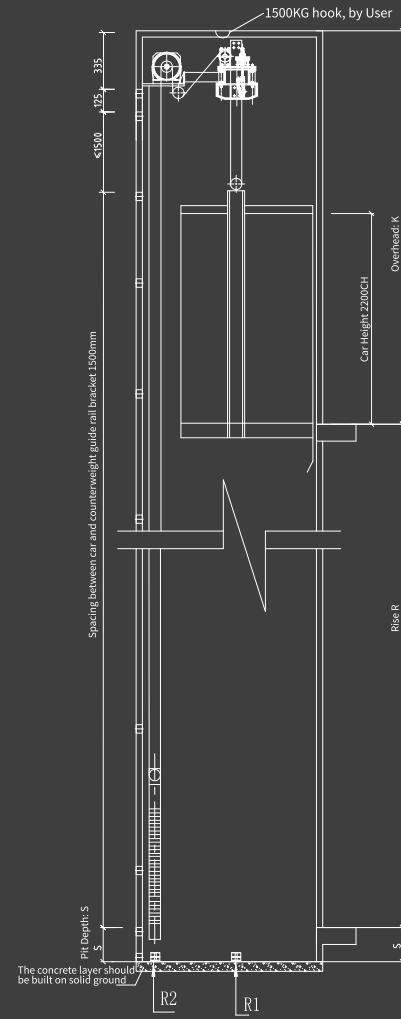

| L | Speed (m/s) | Car Outer Size Width x Depth (mm) | Car Net Size Width x Depth (mm) | Opening Net Size Width x Height (mm) | Hoistway Net Size Width x Depth (mm) | Car Height (mm) | Pit Depth (mm) | Overhead Height (mm) |
|-----|-------------|-----------------------------------|---------------------------------|--------------------------------------|--------------------------------------|-----------------|----------------|----------------------|
| 400 | 0.4 | 1150×1215 | 1100×1100 | 650×2000 | 1450×1600 | 2200 | 300 | 3200 |
| 320 | | 1050×1165 | 1000×1050 | 600×2000 | 1350×1550 | | | |
| 250 | | 1000×1115 | 900×1000 | 600×2000 | 1300×1500 | | | |

Hoistway Elevation Section

i520S-G Side Opening Door with Counterweight Rear Located

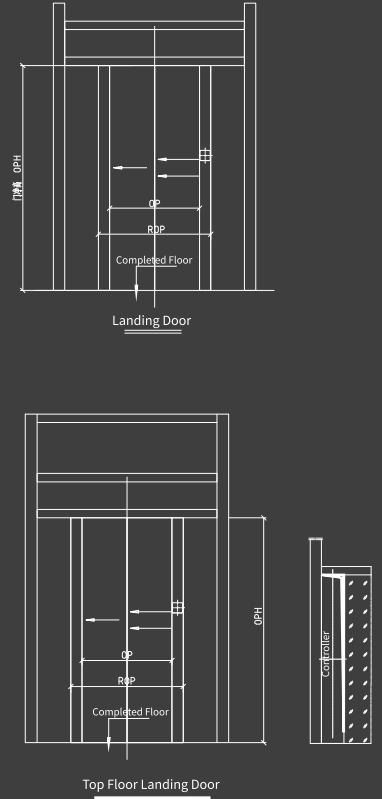
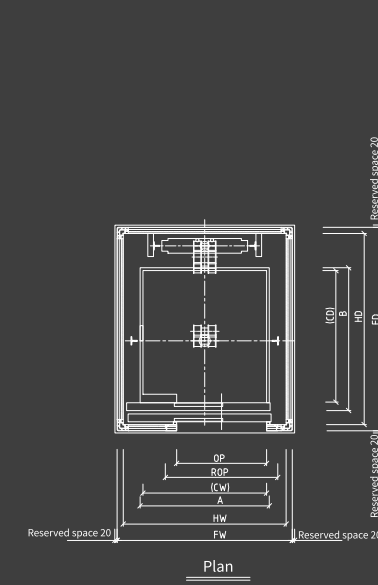
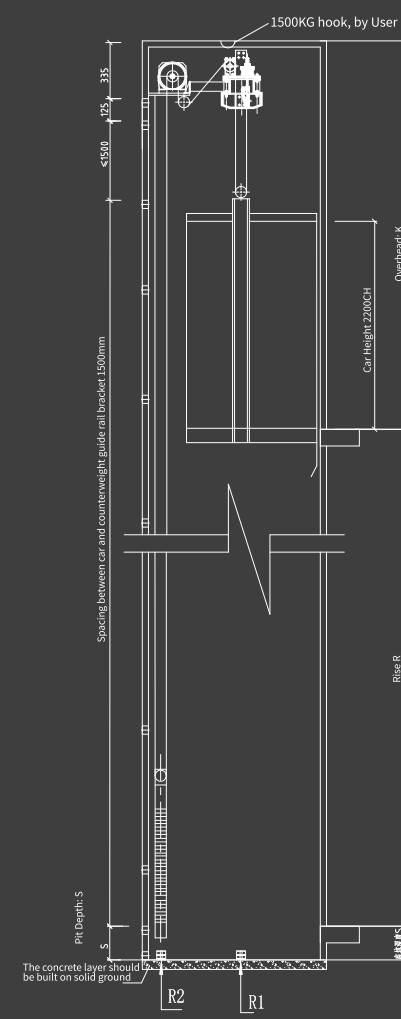

| L | Speed (m/s) | Car Outer Size Width x Depth (mm) | Car Net Size Width x Depth (mm) | Opening Net Size Width x Height (mm) | Hoistway Net Size Width x Depth (mm) | Car Height (mm) | Pit Depth (mm) | Overhead Height (mm) |
|-----|-------------|-----------------------------------|---------------------------------|--------------------------------------|--------------------------------------|-----------------|----------------|----------------------|
| 400 | 0.4 | 1150×1270 | 1100×1100 | 800×2000 | 1450×1700 | 2200 | 300 | 3200 |
| 320 | | 1050×1220 | 1000×1050 | 700×2000 | 1350×1650 | | | |
| 250 | | 1000×1170 | 900×1000 | 650×2000 | 1300×1600 | | | |

Hoistway Elevation Section

Civil engineering layout

i520S-G 4-P Center Opening Door with Counterweight Rear Located

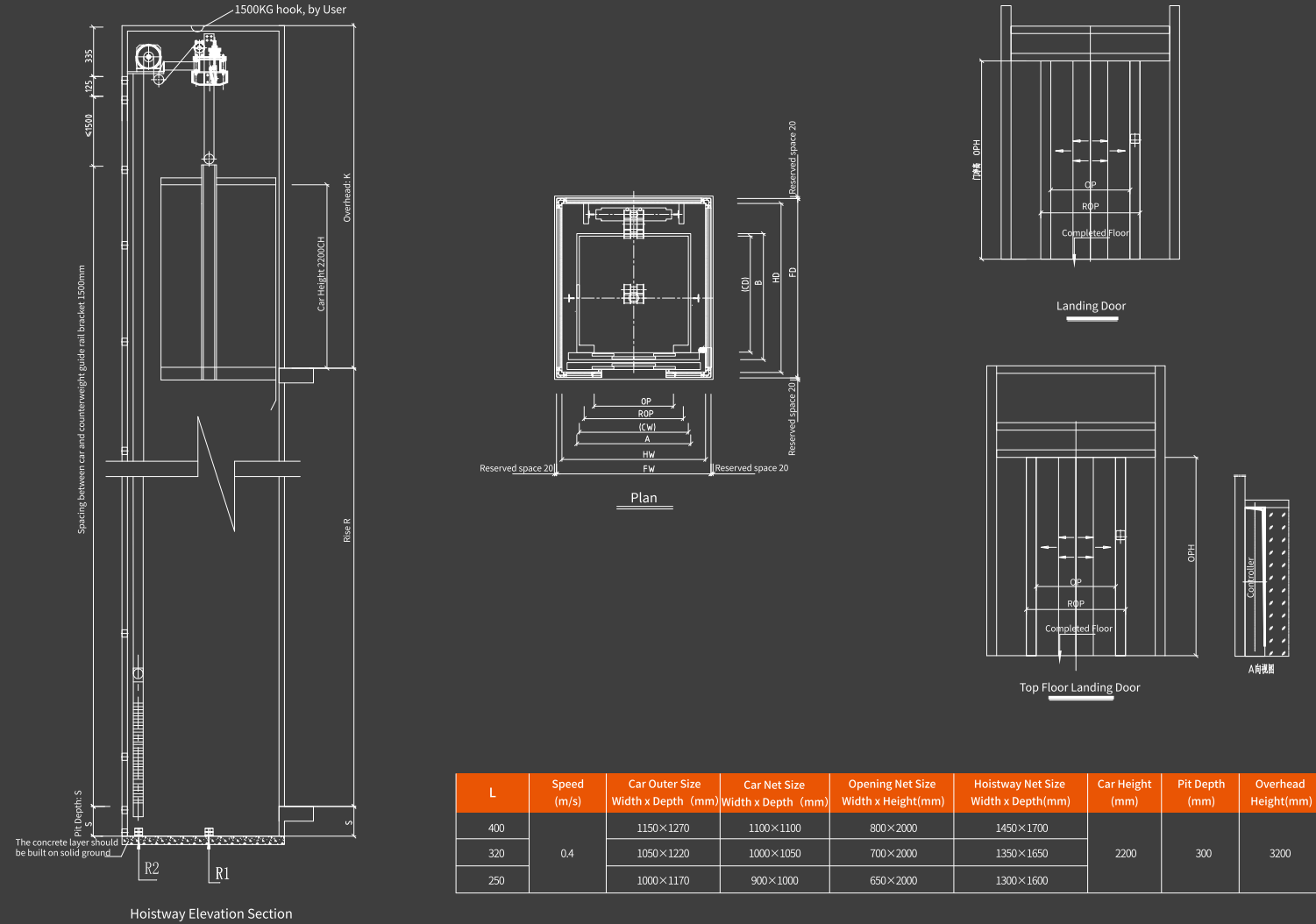

i520S-G Hand Sliding Door with Counterweight Rear Located

