

XIZI2504



 Service Line / 400-826-1112

XIZI ELEVATOR CO.,LTD.
Add/NO.2329 Science and Technology Ave.,
Lin'an Economic Development Zone, Hangzhou, China
[Http://www.xizielevator.com/](http://www.xizielevator.com/)

This book is a general information print (Edition: First Edition, April 2025). We reserve the right to make changes to the product technology and specifications at any time.
The content of the sample is for reference only, and the actual product shall be subject to the contractual agreement between the parties and the actual product.

XIZI ELEVATOR

Freight Elevator

UN-F5000 UN-F5000 mrl

Passenger Elevator Create Infinite Possibility For Building Traffic

XIZI

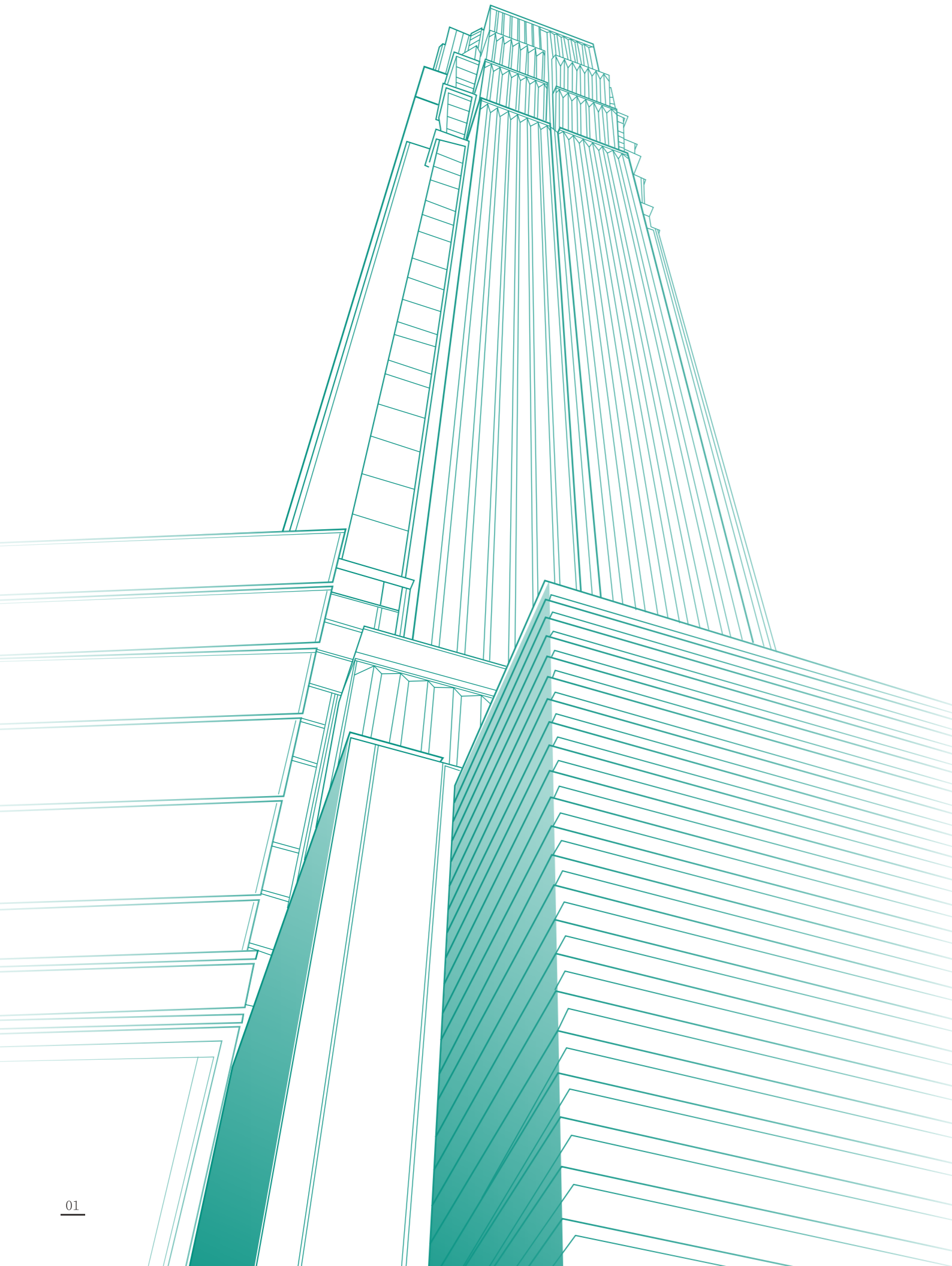

[Pioneer of national brand]

Over 40 years of history

ABOUT XIZI ELEVATOR

XIZI Elevator Co., Ltd. is a comprehensive elevator manufacturing enterprise integrating research and development, manufacturing, sales, installation, and after-sales service. Inheriting over four decades of experience of the **XIZI 西子**® brand, the company boasts strong research and development capabilities and a comprehensive product system. It constantly insists on independent innovation, continuously deepens its domestic market, expands overseas markets, actively creates and develops a global marketing and service network system, and is committed to providing more professional technology, products, and services to customers.



PRODUCT MARKET POSITIONING

FREIGHT LIFT UN-F5000/UN-F5000 mrl

The appearance of freight lift has brought convenience for the transporting, and freight lift with a huge capacity could embody its advantage of transporting better. UN-F5000 freight lift, with a capacity of 2T~5T, at the same time, energy savings can be achieved with energy-efficient control systems.

Main configuration

Speed range	0.25m/s~1.0m/s
Load range	2000kg~5000kg



POWERFUL MOTOR

Permanent magnetic synchronous gearless traction machine

▶ Energy-saving traction machine

The permanent magnet synchronous gearless traction machine is adopted, which does not need excitation, has a small starting current, high transmission efficiency, and a more reasonable structure.



◎ ENERGY SAVING AND ENVIRONMENTAL PROTECTION

Up to 40% more energy efficient than ordinary geared traction machines



◎ COMFORTABLE OPERATION

Adopt imported high precision encoder to make the lift run with a comfortable speed curve



◎ STABLE PERFORMANCE

Professional self-made magnets never demagnetize and maintain the magnetic performance effectively



◎ LOW NOISE

Adopt silent brake device, noise reduction 5~10(dB)A



IR&D original factory and brand

INTELLIGENT CONTROL



◎ SERIAL COMMUNICATION SYSTEM

Adopt the pulse signal, landing display and call only need 4 wires, it will reduce the cost of connection failure and production cost greatly, improve the system reliability, also it will be convenient to upgrade in the future.

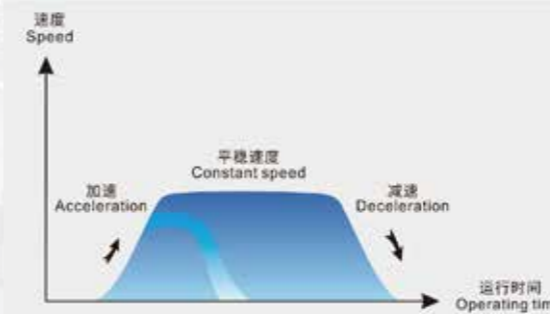

◎ PATTERN GENERATOR

Make the elevator more stable in the process of accelerate, decelerate and braking,, improve the leveling accuracy, reduce the running vibration and running.



◎ PERMANENT MAGNET VVVF DOOR OPERATOR

Adopt the skilled technology of variable frequency drive and control logic, the synchronous door knives device to ensure that open and close car doors synchronously, and run sensitively and safely. The physical design is concise and reasonable, the space is saved, it is easy to install and repair.

SAFETY FUNCTION

● SAFE RELIABLE, WORTH TRUSTING

The door system uses infrared curtain door protection technology with 154 beams, can protect the goods effectively during door opening and closing, which increased a reliable safeguard to the XIZI elevator. The high strength car structure, key component's optimization design has promoted overall construction reliable and security, which effectively guarantees motor transport's security.



● MICRO CONTROL HIGH EFFICIENT RUNNING

Adopt the microcomputer modular control system, with five computer modular in data network system. It can be under the premise of without changing the hardware configuration fields to modify the software, adjust the system parameters, improve the ability of control system upgrade, accurately and efficiently control the drive and function of the elevator.



● STABLE PERFORMANCE LEVELING ACCURATELY

Dedicated graphics generator make run speed curve gently smooth, avoid impact in the process of deceleration and acceleration, and ensure the safety of passengers and cargo stability, high efficiency, leveling accurate, goods transportation.

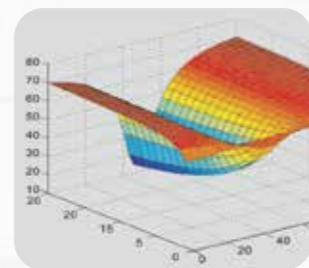

STANDARD DECORATION



STANDARD DECORATION U-CR501

Ceiling: Painting steel (grey)
Car panels: Painting steel (grey)
Light: LED downlight
Floor: Pattern steel (grey)

Color Optional

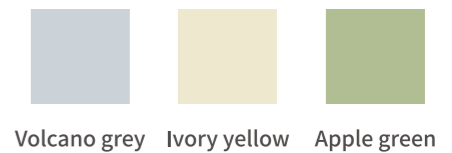

OPTIONAL DECORATION U-CR502

Ceiling: Hairline stainless steel
Car panel: Hairline stainless steel
Light: LED downlight
Floor: Pattern steel (grey)



There is a chromatic aberration between the product picture and the physical object.

STANDARD HUMAN-INTERFACE

COP

U-CF500

Faceplate: Hairline stainless steel



HOP

U-ZW500

Faceplate: Hairline stainless steel

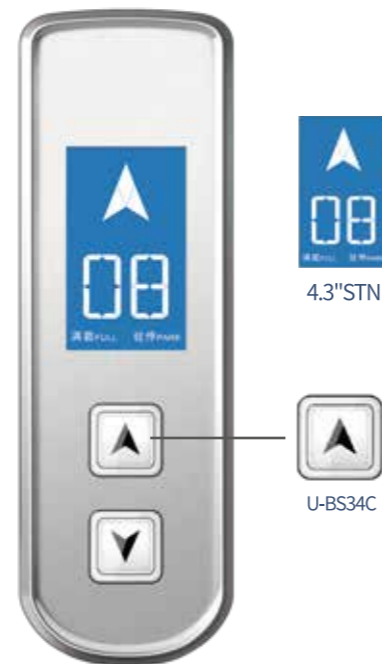

Above name plate is for reference only.

FUNCTION LIST

Notice: The option with * need to confirm with factory first

► Basic Function

- Full collective operation
- Automatic return to base station
- Infrared curtain door protection
- Car top inspection
- Terminal floor protection
- Over load protection
- Door open/close button
- Independent time control of landing door car door
- Hall/ car direction indication
- Hall/ car position indication
- 5-ways intercom
- Car emergency light
- Car alarm bell
- Full load non-stop run
- Door-closing delay protection
- Correction run
- Drive motor overheat protection
- Auto-clear of calls in opposite direction
- Parking switch
- Pre torque output
- Fault self-learning
- Shaft position self-learning
- Brake feedback inspection
- Contractor feedback inspection

- Speed feedback inspection
- Cancel error calls
- Door hold cancel
- Fireman service reminder
- (UCMP) Unintended car movement protection display
- Emergency fire operation
- Independent service
- Attendant Operation
- Fan and light protection
- Emergency rescue operation
- Car chime

► Optional Function

- Photoelectric and safety edge double protection
- Emergency fireman operation(EFO)*
- Auto parking
- Non stop button
- Door hold button
- Duplex control / group control
- Area monitoring system*
- Auto rescue device
- Elevator air conditioner*
- Timing setting*
- Earthquake operation*

*Refers to sales for more information.

LAYOUT

UN-F5000

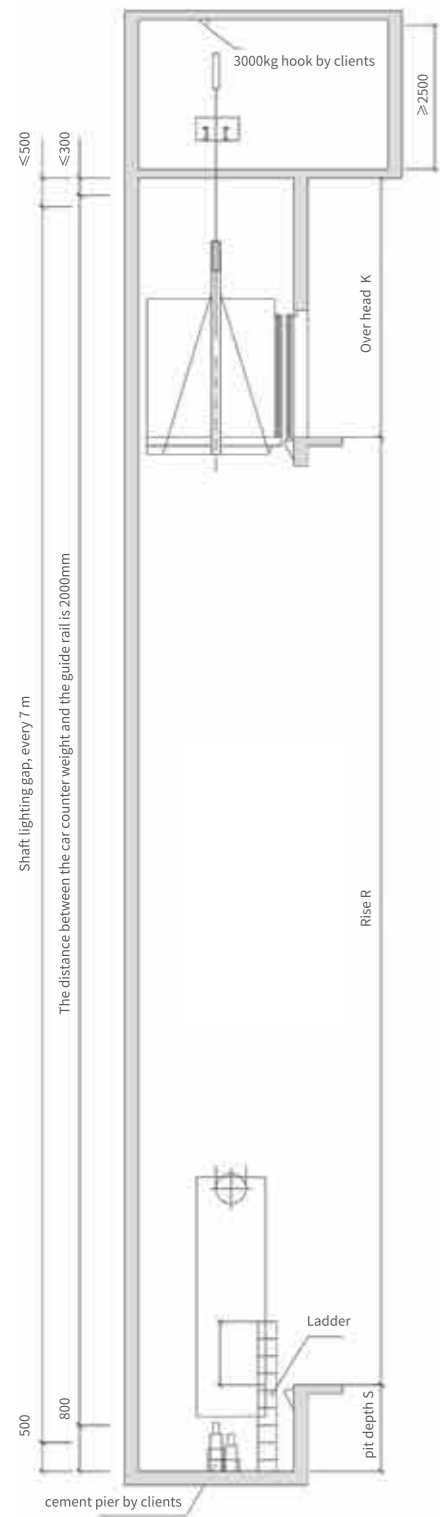

Hoistway section plan

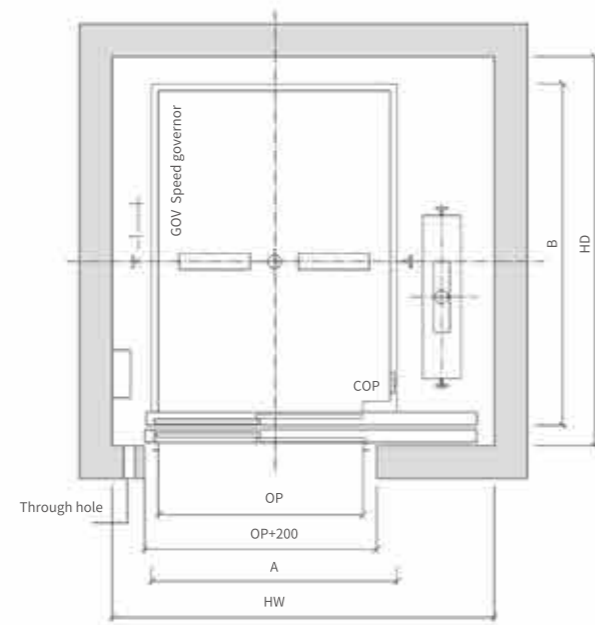

Hoistway plan (2000kg)

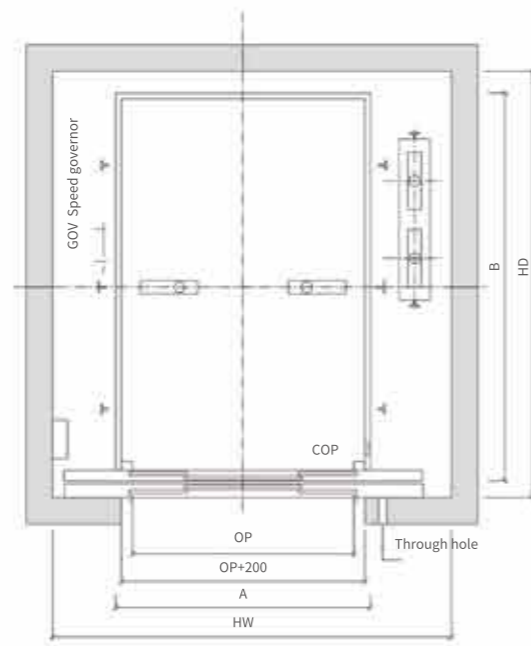

Hoistway plan (3000~5000kg)

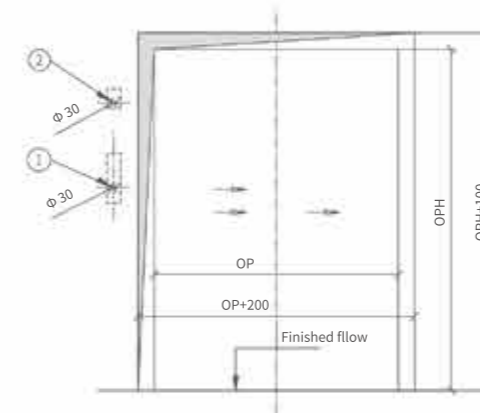

All floors

- 1: Buttons and display
- 2: only for base station

(2000kg) Front door view

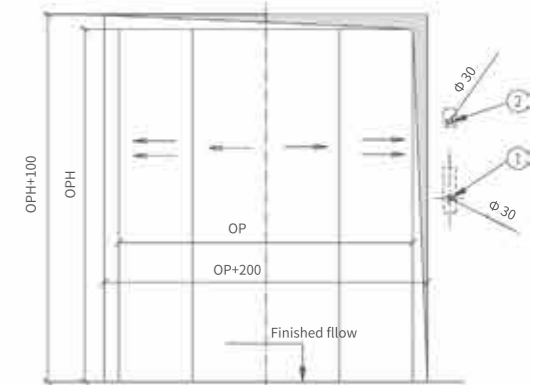

All floors

- 1: Buttons and display
- 2: only for base station

(2000kg-5000kg) Front door view

Capacity (kg)	Speed (m/s)	Cabin outer size A(mm) × B(mm)	Opening size OP(mm) × OPH(mm)	Shaft inner size HW(mm) × HD(mm)	Min Pit depth S(mm)	Min Overhead K(mm)
2000	0.5	1800X2500	1500X2100	2800X2800	1500	4500
	1.0					
3000	0.5	2100X2800	2000X2100	3450X3100	1500	4800
	1.0					
4000	0.25	2100X3600	2000X2400	3450X3900	1500	4800
	0.5					
5000	0.25	2500X3600	2400X2400	3950X3900	1500	4800
	0.5					

*All above is for reference only.

LAYOUT

UN-F5000 mrl

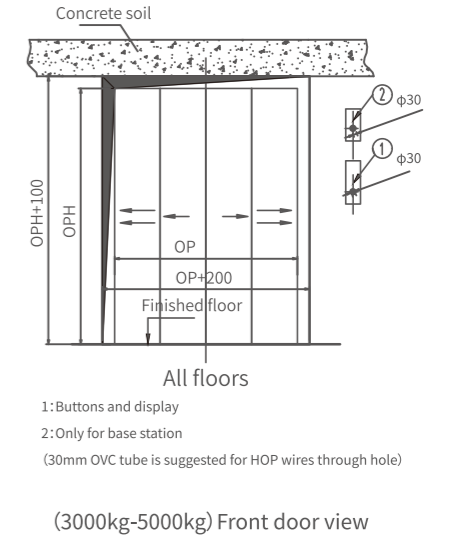
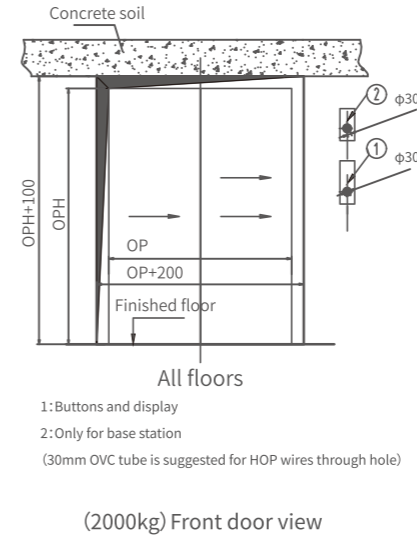
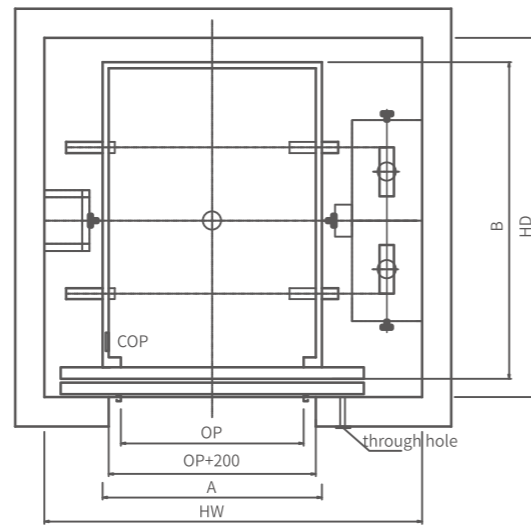
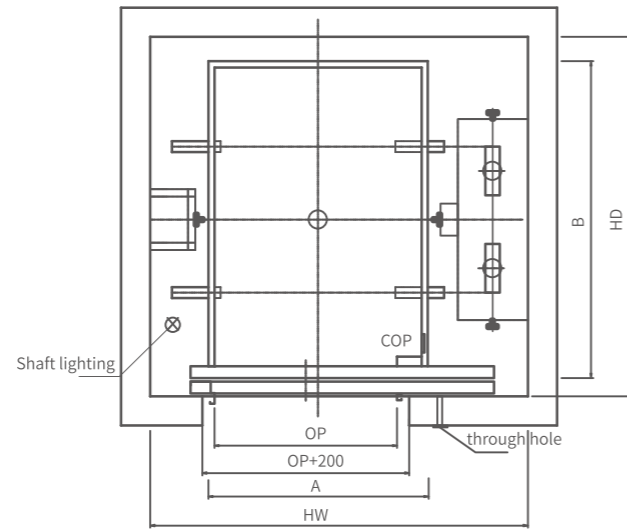
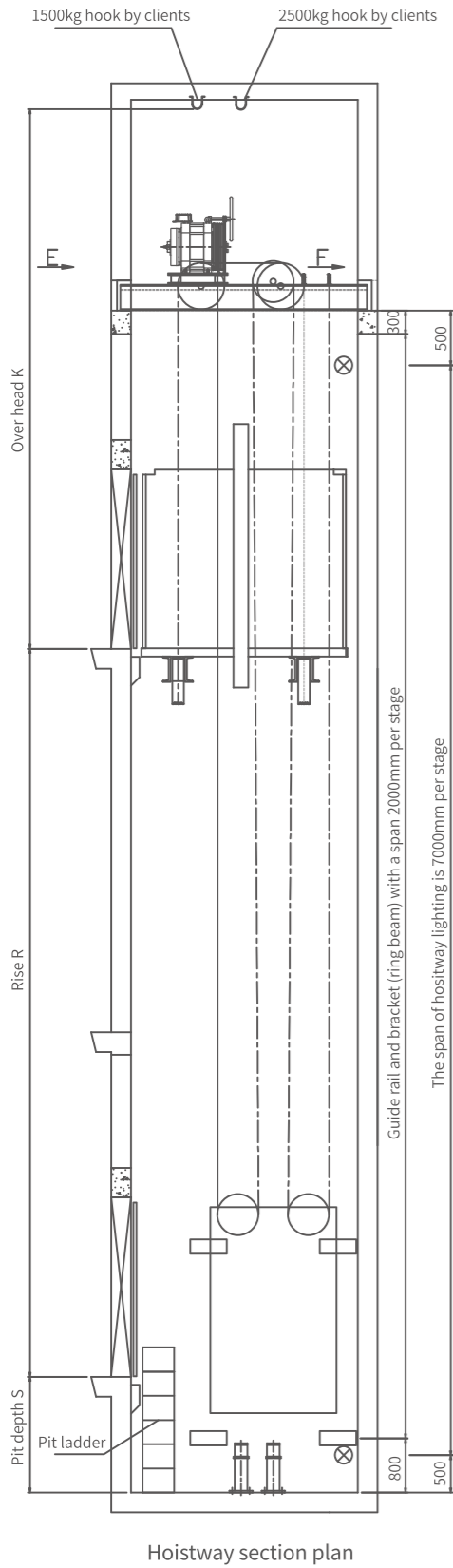

Capacity (kg)	Speed (m/s)	Cabin outer size A(mm)×B(mm)	Opening size OP(mm)×OPH(mm)	Shaft inner size HW(mm)×HD(mm)	Min Pit depth S(mm)	Min Overhead K(mm)
2000	0.5	1800X2500	1500X2100	3250X2800	1500	4500
	1					
3000	0.5	2100X2800	2000X2100	3650X3100	1650	5000
	1					
4000	0.25/0.5	2100X3800	2000X2400	3800X4100	1800	5800
5000	0.25/0.5	2500X3800	2400X2400	4200X4100	1800	5800

*All above is for reference only.